

SCOPE OF USE

The options offered in this section provide quick reference solutions for the fire protection of structural steel columns and beams.

For engineered solutions, tailored to meet specific column and beam sizes and loading conditions, specific fire engineering design is required.

For further assistance contact the GIB® Helpline 0800 100 442.

FRR (STABILITY RATING IN MINUTES*)	LINING REQUIREMENT COLUMNS AND BEAMS
15	1 x 13mm GIB® Standard
30	1 x 16mm GIB Fyreline®, or 2 x 10mm GIB Fyreline®
60	2 x 13mm GIB Fyreline®
90	2 x 16mm GIB Fyreline®
120	2 x 19mm GIB Fyreline®

* The FRR comprises values for stability/integrity/ and insulation. For loadbearing structural steel members (primary elements) the stability rating is usually the only requirement and prevents collapse during a fire. If the structural member is an integral part of a fire rated wall or floor/ceiling system, then integrity and insulation values may apply. In this case the systems will achieve equal values, e.g. 30/30/30.

STRAPPING

Strap column or beams with a nominal 50mm x 50mm timber cradle frame ensuring that the linings are supported by framing members spaced at 600mm centres maximum.

LINING

Install the linings in accordance with the required FRR as specified above.

First and second layer joints must be formed over framing. In double layer systems, the joints between the first and second layer must be offset by 300mm minimum.

FASTENING THE LINING

Fasteners

GIB® Grabber® High Thread Drywall Screws.

The fastener length must ensure a 20mm minimum penetration into the timber framing.

Fastener Centres

Each layer must be fixed at 300mm centres maximum to framing spaced at 600mm centres maximum.

JOINTING

INNER LAYER: Unstopped

OUTER LAYER: All fastener heads stopped and all sheet joints tape reinforced and stopped in accordance with the publication entitled "GIB® Site Guide".

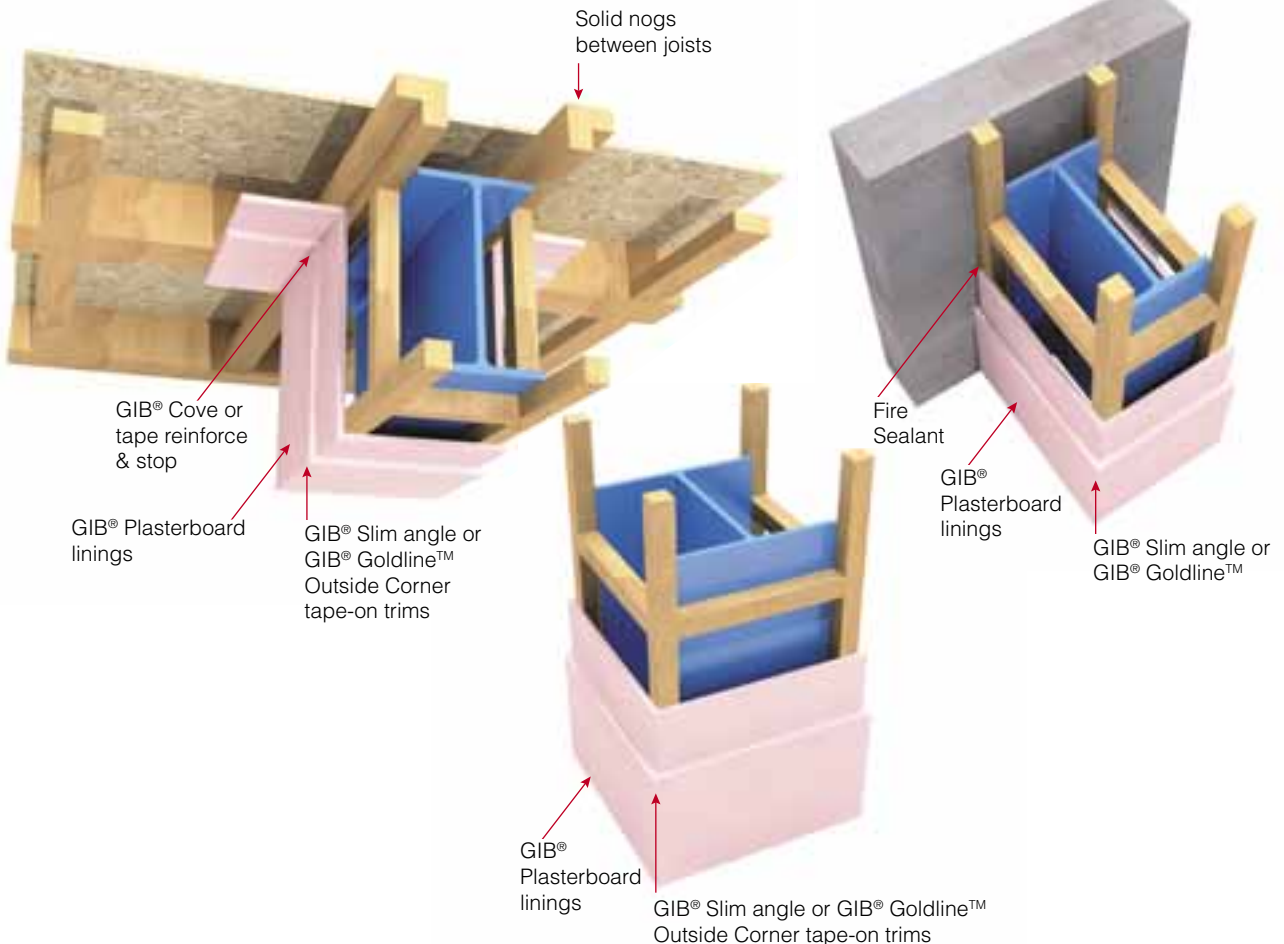

In order for GIB® systems to perform as tested, all components must be installed exactly as prescribed. Substituting components produces an entirely different system and may seriously compromise performance. Follow system specifications.



SCOPE OF USE

The options offered in this section provide quick reference solutions for the fire protection of structural steel columns and beams.

For engineered solutions, tailored to meet specific column and beam sizes and loading conditions, specific fire engineering design is required.

For further assistance contact the GIB® Helpline 0800 100 442.

FRR (STABILITY RATING IN MINUTES*)	LINING REQUIREMENT COLUMNS AND BEAMS
15	1 x 13mm GIB® Standard
30	1 x 16mm GIB Fyrelite®, or 2 x 10mm GIB Fyrelite®
60	2 x 13mm GIB Fyrelite®
90	2 x 16mm GIB Fyrelite®
120	2 x 19mm GIB Fyrelite®

* The FRR comprises values for stability/integrity/ and insulation. For loadbearing structural steel members (primary elements) the stability rating is usually the only requirement and prevents collapse during a fire. If the structural member is an integral part of a fire rated wall or floor/ceiling system, then integrity and insulation values may apply. In this case the systems will achieve equal values, e.g. 30/30/30.

CLIP AND CHANNEL

Attach Rondo® Clip (part No. BMCL) to column or beam at 600mm centres maximum. Insert Rondo® Furring Track (part No. 140) into clips. Ensure that the linings are supported by framing members at 600mm centres maximum.

For beams exposed on three sides. Rondo® Angle (part No. NZ 18) is to be secured to provide fixing for the linings. The Rondo® Angle must be fixed to the underside of the floor at 600mm centres maximum. The Rondo® Angles are to be fixed at a maximum of 100mm centres in from each end.



LINING

Install the linings in accordance with the required FRR as specified above.

First and second layer joints must be formed over framing. In double layer systems, the joints between the first and second layer must be offset by 300mm minimum.

FASTENING THE LINING

Fasteners

Use GIB® Grabber® Drywall Screws. The screw length must ensure a 12mm minimum penetration into the steel framing.

Fastener Centres

Each layer must be fixed at 300mm centres maximum to framing spaced at 600mm centres maximum.

JOINTING

INNER LAYER: Unstopped

OUTER LAYER: All fastener heads stopped and all sheet joints tape reinforced and stopped in accordance with the publication entitled "GIB® Site Guide".

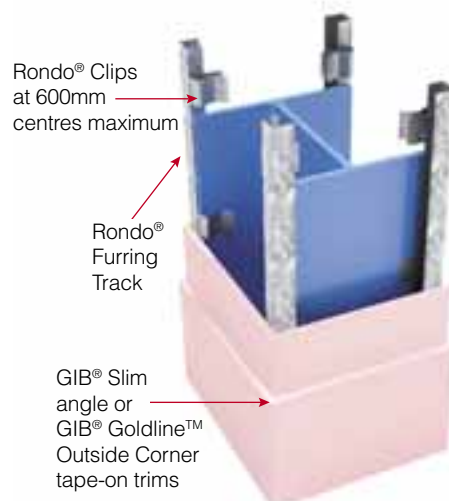
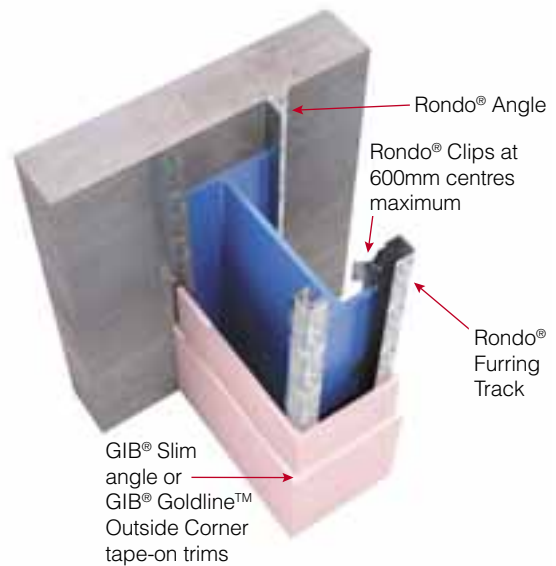

In order for GIB® systems to perform as tested, all components must be installed exactly as prescribed. Substituting components produces an entirely different system and may seriously compromise performance. Follow system specifications.