



SPEC No.	LOADBEARING CAPACITY	STC	RW	IIC	FIRE RESISTANCE RATING	LINING REQUIREMENTS
GBSCA 45	LB	57	57	* 72	45/45/45	2 x 13mm GIB Fyreline®

FLOOR FRAMING

Floor joists shall comply with NZS 3604. Joists shall be spaced at 600mm centres maximum and shall have a depth of 150mm minimum.

FLOORING

Minimum flooring shall be 20mm thick particle board or minimum 17mm thick structural plywood fixed to the joists in accordance with the manufacturer's instructions. Nogs are required behind sheet joints. If tongue and groove flooring is used verification of performance must be obtained from the supplier of the flooring system.

SUSPENSION SYSTEM

USG DONN® ScrewFix™ steel frame suspension system comprising 2.5mm wire hangers at 1200mm centres supporting DJ38 strongback channels spaced at 1200mm centres and FC37 furring channels spaced at 600mm centres maximum. An alternative suspension system with at least equivalent layout, material properties, strength and stiffness may be used. The suspension system shall be installed in accordance with the manufacturer's instructions. The cavity depth shall be 275mm minimum (i.e. the distance between the underside of the flooring and the top of the ceiling linings).

SOUND CONTROL INFILL

Ceiling overlaid with R1.8 (75mm) Pink® Batts® glasswool insulation.

CEILING LINING

2 layers of 13mm GIB Fyreline® fixed at right angles to the furring channels. Offset the joints of the outer layer by 600mm from those of the inner layer. All sheet end butt joints must occur on the furring channel with those of the outer layer offset from those of the inner layer. Sheet joints are touch fitted.

FASTENING THE LINING

Fasteners
 INNER LAYER: 25mm x 6g GIB® Grabber® Self Tapping Drywall Screws.
 OUTER LAYER: 41mm x 6g screws as above.
Fastener Centres (both layers)
 200mm centres around the ceiling perimeter and along each furring channel.
 100mm centres where sheet end butt joints occur.
 Place fasteners no closer than 12mm to the sheet edges.

ACOUSTIC SEALANT

A bead of GIB Soundseal® acoustic sealant is required on the inner lining around the ceiling perimeter. The outer lining is then bedded onto the bead.

WALL/CEILING JUNCTIONS

The internal angle between the ceiling and walls are finished with GIB-Cove® adhered with GIB-Cove® Bond, or boxed corners (square stopped) filled and taped in accordance with the publication entitled "GIB® Site Guide".

JOINTING

INNER LAYER: Unstopped.
 OUTER LAYER: All fastener heads stopped and all sheet joints tape reinforced and stopped in accordance with the publication entitled "GIB® Site Guide".

*** IMPACT INSULATION CLASS (IIC)**

A performance of IIC 46 is achieved with a bare floor.
 A performance of IIC 47 is achieved with a cushion backed vinyl on particle board or structural plywood.
 A performance of IIC 72 is achieved with a 48oz hard twist wool hessian backed carpet over a rubber waffle underlay.

Note: See page 61 for ceiling perimeter details.

USG DONN® ScrewFix™ suspension system

2 layers of 13mm GIB Fyreline®

R1.8 (75mm) Pink® Batts®

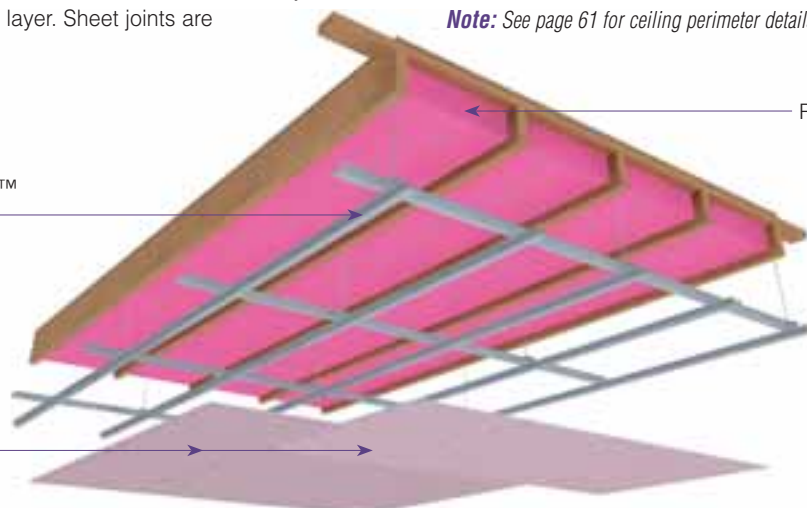

In order for GIB® systems to perform as tested, all components must be installed exactly as prescribed. Substituting components produces an entirely different system and may seriously compromise performance. Follow system specifications.