

# GIB® NOISE CONTROL SYSTEMS – SUB-INTERTENANCY

## Two Way FRR – GIB® Rondo® Quiet Stud® Steel Frame MARCH 2006

SPEC No.	LOADBEARING CAPACITY	STC	RW	FIRE RESISTANCE RATING	LINING REQUIREMENTS
GBQSA 60	NLB	50	50	-/60/60	1 x 13mm GIB Noiseline® each side

### FRAMING

GIB® Rondo® Quiet Stud® resilient steel stud 92 x 45 x 0.55mm nominal and placed in 92 x 30 x 0.55mm nominal steel channel. Channel is fixed to floor and ceiling. Studs are “friction fitted” at 600mm centres maximum with a 15mm expansion gap at the top of the frame. No fixings to the top channel.

### WALL HEIGHTS

Recommended maximum wall height is 3600mm. For higher walls consult the framing manufacturer.

### SOUND CONTROL INFILL

R1.8 (75mm) Pink® Batts® glasswool insulation installed between the studs.

### LINING

1 layer of 13mm GIB Noiseline® fixed vertically each side of the frame. Vertical joints are offset 600mm from those of the opposing side. Sheets must be fitted hard to floor. Use full height sheets where possible. Sheet joints are touch fitted and must occur over framing. Where sheet end joints are unavoidable they must be over nogs.

### ACOUSTIC SEALANT

A bead of GIB Soundseal® acoustic sealant is required around the perimeter of the frame, the lining is then bedded onto the bead.

### FASTENING THE LINING

#### Fasteners

25mm x 6g GIB® Grabber® Self Tapping Drywall Screws.

#### Fastener Centres

300mm centres up each stud.

Place fasteners 12mm from sheet edges generally and 50mm from sheet ends.

### JOINTING

All fastener heads stopped and all sheet joints tape reinforced and stopped in accordance with the publication entitled “GIB® Site Guide”. Wall to ceiling junctions are to be reinforced with paper tape and square stopped or finished with GIB-Cove®.

STUD SIZE	SPACE BETWEEN FRAMES	PARTITION WIDTH
92 x 45 x 0.55mm	N/A	118mm

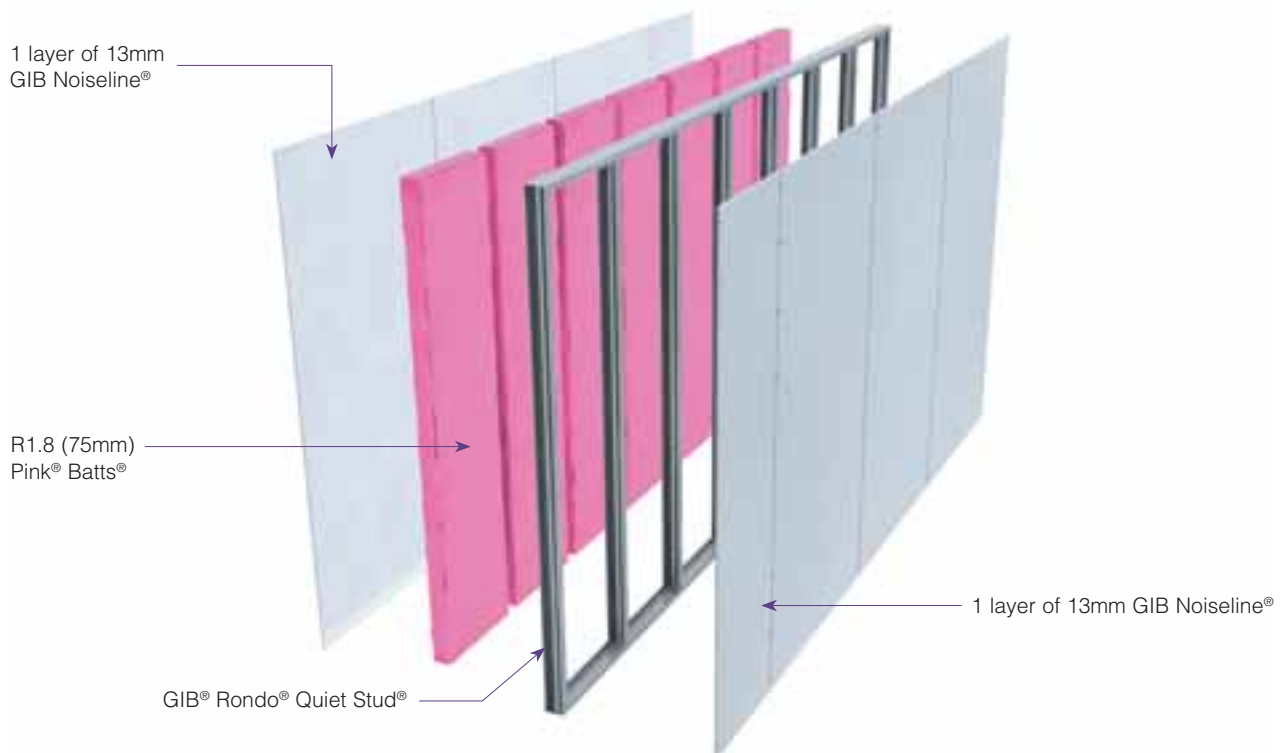

In order for GIB® systems to perform as tested, all components must be installed exactly as prescribed. Substituting components produces an entirely different system and may seriously compromise performance. Follow system specifications.