

Universal Beam (UB) example

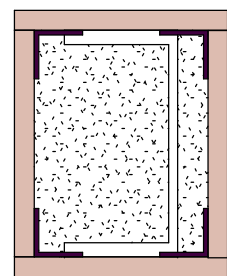

Parallel Flange Channel (PFC) example

**NOTE:**

- Refer to GFS507 for the hollow section penetration detail
- 64 x 34 x 0.5mm or larger steel member penetrations only
- Maximum steel thickness shall not exceed 20mm for an FRR up to and including 60 minutes, and 10mm for FRRs of 90 and 120 minutes

