

Square Hollow Section (SHS) example

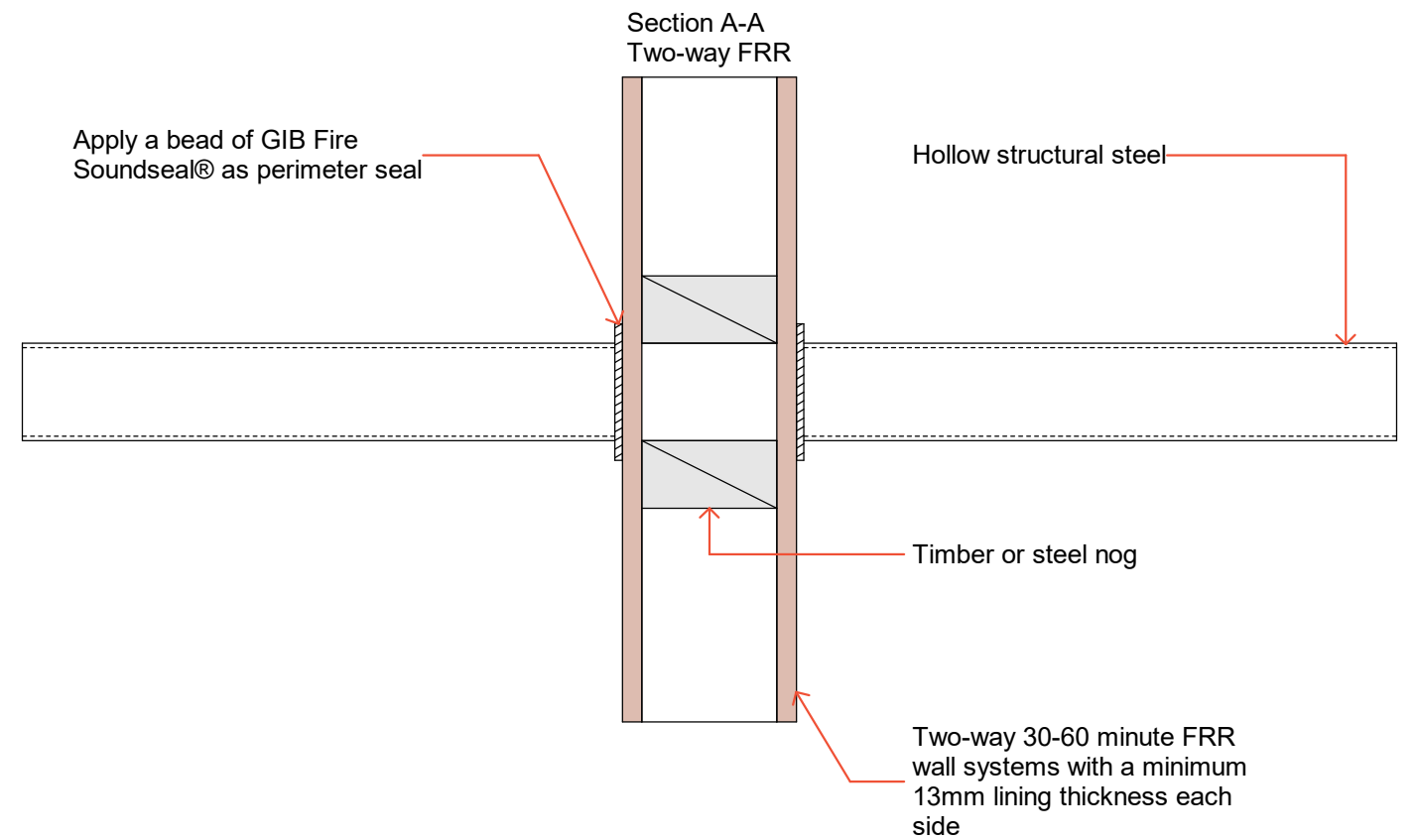

Construction	Size	FRR
Two-way 30-minute FRR wall system	50 x 50 x 2.5mm	-/30/30
	Other sizes up to 200 x 200mm with a minimum 2.5mm wall thickness	-/30/-
Two-way 60-minute FRR wall system	50 x 50 x 2.5mm	-/60/30
	Other sizes up to 200 x 200mm with a minimum 2.5mm wall thickness	-/60/-