



Best Practice Series

No 1 - Wet Area systems



7 THINGS TO CONSIDER WHEN INSTALLING GIB AQUALINE® - WET AREA SYSTEMS

- 01. Always use GIB Aqualine® on walls and ceilings to help protect against moisture and steam damage.
- 02. Use waterproof membranes in the right areas - such as to the edge of showers, baths and vanities to be tiled.
- 03. To provide stability use a GIB® Rondo® NZ18 or GIBFix® metal angle attached to the internal corner of timber framed shower walls.
- 04. Fix GIB Aqualine® horizontally where possible to reduce joints and improve the finish.
- 05. Use 13mm GIB Aqualine® on ceilings to protect against moisture and steam.
- 06. When tiling*, fasteners are required at 100mm centres to the perimeter of the sheet and to all intermediate studs.

**10mm GIB Aqualine® is for tile weights up to 20kg/m² and 13mm GIB Aqualine® up to 32kg/m². Most wall tiles weigh under 20kg/m².*

Enclosed Shower over bath

	Code Requirement
	Good Practice

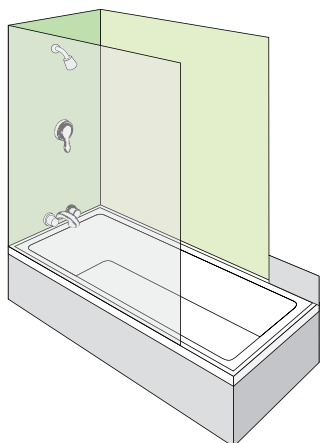

03. To provide stability use a GIB® Rondo® NZ18 or GIBFix® metal angle attached to the internal corner of timber framed shower walls.

Vertical corner
GIB® Rondo®
 NZ18 32 x 32 x 0.55mm
 or GIBFix® 45 x 45 x 0.55mm galvanised steel angle to a minimum height of 1800mm.

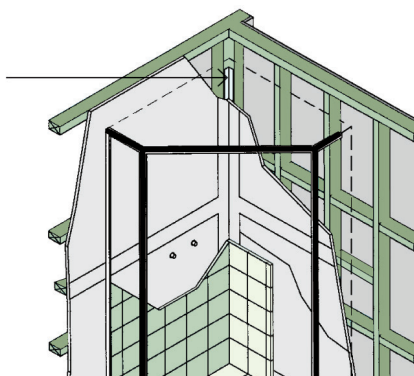

Fixing bracing elements

Screws as specified 100mm centres.

GIB Aqualine®

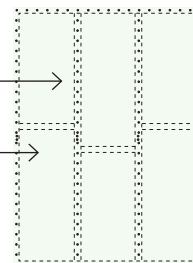

07. Bracing systems must not be located behind showers or baths because of durability requirements, renovation likelihood and other practical issues relating to fixing bracing elements.

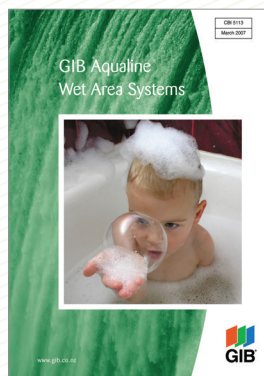

The GIB Aqualine® Wet Area Systems literature contains all the information you'll need to correctly install GIB® Wet Area Systems.