



"Unprecedented"

TALKING TRADE

by Russell Pedersen
Technical Support
and Training Manager



Since Covid-19 hit the word unprecedented has been way over used, quite simply it means, unrivaled or never seen before. It is often used in a negative context and as an excuse for not being able to cope with the change.

The reality is we are all in the same boat and having to adapt. Looking for the silver lining, we are given the opportunity to try new ideas and new ways of doing things which we may never have

ventured out into trying... because "hey, it was working fine..."

In response to what Covid-19 has presented us all with we have seen companies come against a brick wall and suffer, others have been quick to adapt and survive, some even grow.

How has Winstone Wallboards dealt with the changes?

With only a few days notice the GIB® Contact Centre and the GIB® Technical Helpline teams were able to set up and 'WFH' (for those struggling to keep up, that means Work From Home). We were able to offer continued technical support throughout the Lock down period.

Additionally, we rolled out Online CPD and LBP content. We already had a number of 'How-to-videos' available

but the suite of recorded webinars, 'How-to-videos' and guest presenting at live events grew significantly.

We have also made the decision to move to a monthly news update with GIB® NewsBites. A printed GIB® News edition will continue to be published twice a year.

While we are continuing with our live GIB TradeTalk® events around the country, we have also added regular GIB TradeTalk® Webinar events, with great success!

If you would like to join us for one of our next events click on the links below, or call the GIB® Helpline on 0800 100 442.

[Links to trainings, resources and events:](#)

[CPD Learning Resources](#)

[LBP Learning Resources](#)

[Sign up for updates](#)



NEW GIB LITESET® BASECOAT COMPOUND AVAILABLE

PRODUCT

by Edwin Zijderveld
Product Manager



This new GIB® compound has been developed from lots of feedback and trials with stoppers. As always, user feedback is much appreciated and invaluable.

GIB LiteSet® has some key benefits.

- A new basecoat jointing compound that can be sanded and is easy to scrape.
- A very stable viscosity during the 90 minute work life for a nice uniform application. It only thickens up near the very end of this period to warn the working time has nearly finished.
- GIB LiteSet® is suitable for bedding in the reinforcing jointing tape as well as the second coat (in a three coat jointing process).
- Creates a strong joint between plasterboard sheets.
- Has improved rheology when applied by trowel or box, with a slick flow for easy application.



Try this new GIB® compound today. Available at your local GIB® compound stockists.

For more information go to gib.co.nz/compounds or call the GIB® Helpline 0800 100 442.

MULTI-STOREY ACOUSTIC SOLUTIONS

CASE STUDY

by Hamish Ewan
Senior Technical
Engineer



Wall types	GIB® specification number	FRR	STC	Partition width	Recommended maximum wall height
Double C-section steel frame	GBSA 60c	-/60/60	59	186mm	2700mm
Single GIB® Rondo® Quiet Stud® steel frame	GBQSA 60a	-/60/60	55	128mm	3800mm
Connected central barrier double steel frame	GBSAB 60e	-/60/60	57	193mm	4000mm

Many people engaged in the design and construction of lightweight terrace homes will have seen the shift to central barrier type intertenancy walls over recent years. The advantages that the central barrier type walls bring to the table are undeniable.

These advantages include:

01. High levels of FRR and STC performance;
02. The ability to penetrate wall linings with electrical and plumbing services (within certain limitations) without the need to fire seal those penetrations;
03. Wall linings can terminate at ceiling level.

GIB Noise Control® Systems include several central barrier type wall specifications that are suitable for lightweight terrace home designs.

But what about large-scale apartment buildings? These types of designs typically utilise a primary structure made from steel and/or reinforced concrete, which then have non-load bearing partitions added to form the external and internal walls. Do the designers and builders of these large-scale apartment buildings have any viable central barrier type intertenancy wall options? The answer is yes, they do.

The traditional framing material utilise for non-load bearing partitions in large-scale apartment buildings is light gauge steel. This is driven by cost and framing depth considerations. A narrower partition wall results in more usable floor area. Common framing arrangements for intertenancy partition walls include double C-section steel frame and single GIB® Rondo® Quiet Stud® steel frame. A relatively new option is the connected central barrier type wall constructed

from a double C-section steel frame. Examples of each of these three types of non-load bearing intertenancy wall specifications are shown in the table above. They, along with numerous other specifications, all appear in the GIB Noise Control® Systems Manual.

Whilst the FRR and STC performance of these three wall specifications are the same or similar, the construction of each one is very different. This can be seen by looking at the 3D views below. What can't be seen however are the inherent advantages that come with connected central barrier specification GBSAB 60e. Not only can it stretch to a maximum wall height of 4000mm when constructed from standard 64 x 34 x 0.50mm steel framing, it can also accommodate unprotected electrical and plumbing penetrations through the wall linings (within certain limitations). This

advantage over the other wall types can translate into a welcome reduction in the passive fire protection budget for the project. Having that uninterrupted central barrier also provides an additional level of confidence that the final installation will achieve the claimed levels of FRR and STC performance.

Download the 'Case Study' document or contact the GIB® Helpline on 0800 100 442 for further information.



BELOW Figure 1: GIB Noise Control® System specification number GBSA 60c.

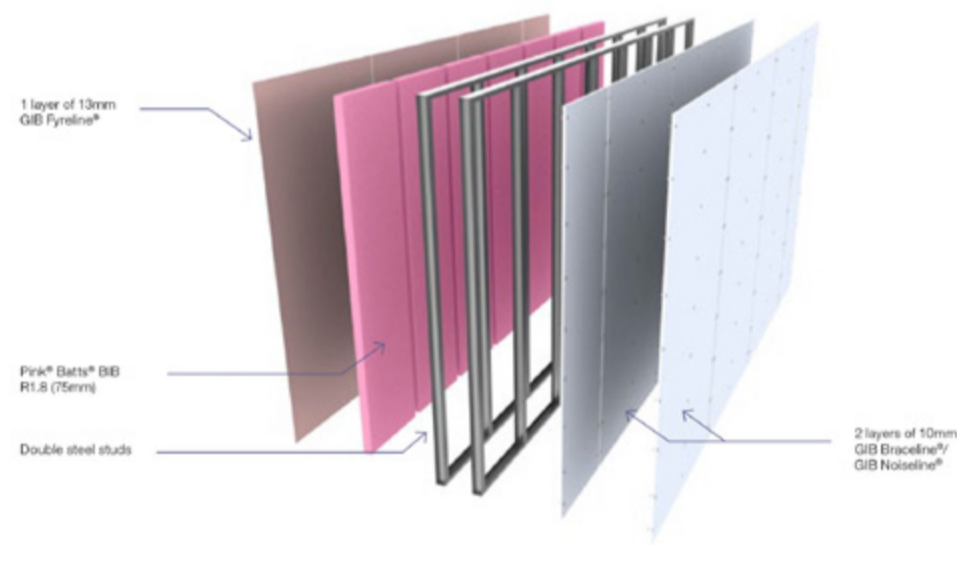

BELOW Figure 2: GIB Noise Control® System specification number GBQSA 60a.

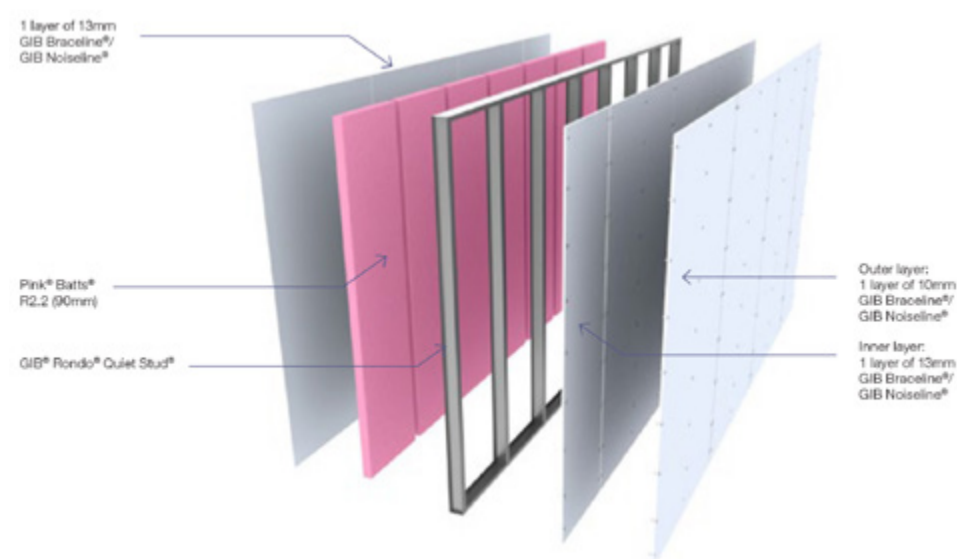

BELOW Figure 3: GIB Noise Control® System specification number GBSAB 60e.

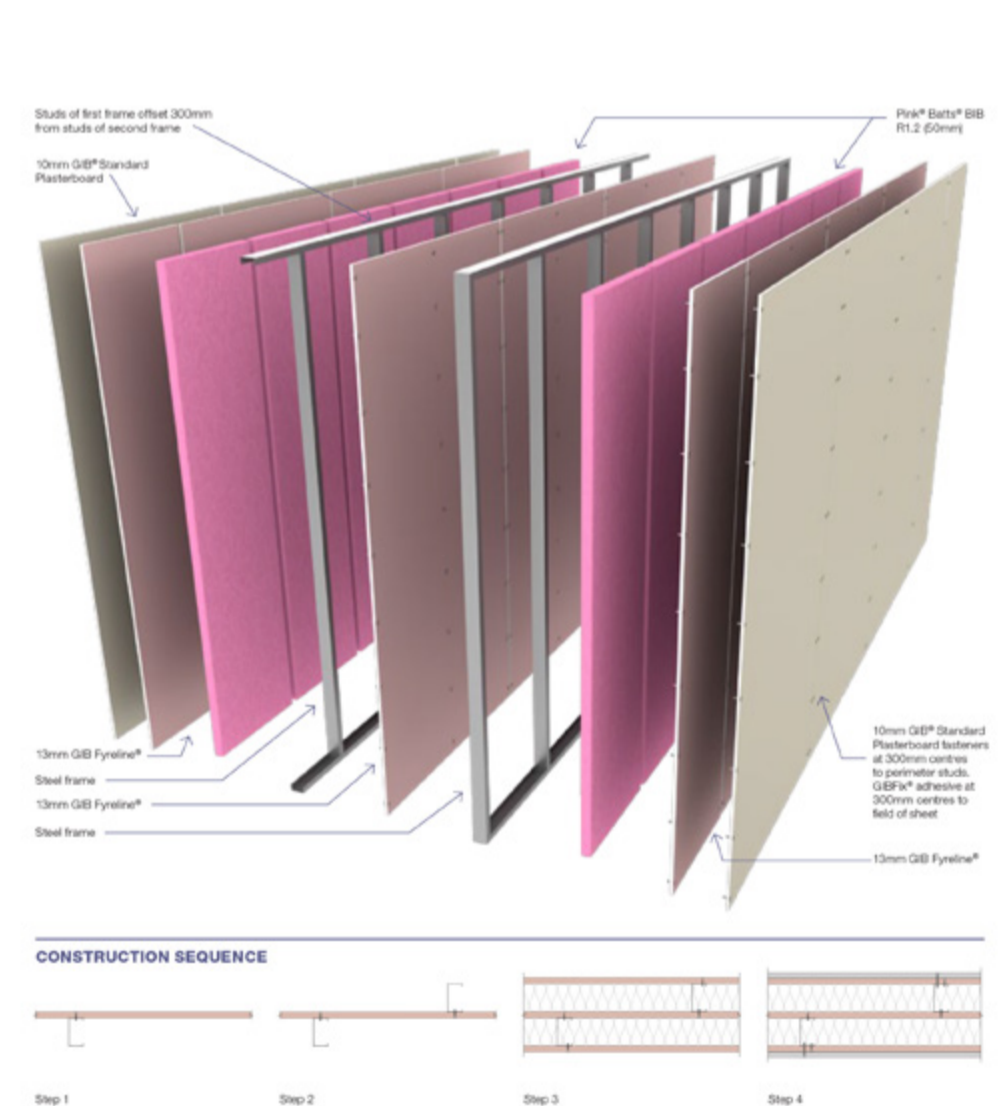

INSTALLATION A BREEZE WITH NEW LENGTH GIB WEATHERLINE®

CASE STUDY

by Clara Sumner
Partnership Manager



Winstone Wallboards' new length GIB Weatherline® is proving to be a big hit with the tradies. Cut to size at 2450mm x 10mm, it minimises the need for onsite cutting (except for the likes of gable ends), creates minimal waste, and is super quick to install.

In fact, builder and Club GIB® Installer Keith Cochrane of Cochrane and Associates, Christchurch, couldn't believe how quickly his team had the GIB Weatherline® up on a recent residential project.

"It's so much faster than plasterboard to install as you don't have the likes of light box cut outs. Sure, bracing may be required, but there's no gluing or cutting around door heads," says Keith.

Working with a 204m² floor area, it took two men 14 hours to install board and tape, using 53 sheets of the new length GIB Weatherline® and 6000 screws. From the foundation being placed, to the GIB Weatherline® and windows being installed, it took just two months, and

with windows and the temporary garage door in place, the house was secure.

"It was great to have the building closed in, particularly in the cooler, wetter months. We also noticed that as soon as the GIB Weatherline® went up the framing started to dry."

Although the fibre in the core of the board was a little harder on the hands, Keith found it was nothing a pair of gloves couldn't remedy. The 'GIB Weatherline® Materials Order Form' also came into its own – although it did catch the team out first time round.

"The order form told us we needed 3000 screws, but we ended up using 6000. That's because we didn't keep in mind the fastener pattern requirements. This particular house is in a high wind zone, so the fastener centres needed to be closer for bracing therefore more screws were required. The guides for the tapes and boards were pretty accurate though."

Installing the tapes on Keith's second job proved much faster, as his team had picked up some clever techniques to speed up the process.

"When screwing sheets, if a centre line is not present, it's a good idea to mark one up on the sheet. This means the screws are nicely aligned. The tapes are easier to install over a nice straight line of screws."

"I also recommend working in pairs when installing window tapes as it makes it quicker and the tapes are easier to handle. With a bit of guidance and experience they are not a problem to install."

Keith's step-by-step guide to installing internal and external tapes:

- Fold the tape in half long ways.
- Remove the backing paper from one side of the tape only.
- Place and stick one side, then remove the backing paper from the second half.
- Place and stick.

Download the 'Case Study' document or contact the GIB® Helpline on 0800 100 442 for further information.

GREEN GORILLA PLASTERBOARD RECYCLING NOW AVAILABLE AS PART OF THE AUCKLAND GIB® DTS SERVICE

SUSTAINABILITY

by Gordon White
Market Manager -
Residential



Simple, quick and efficient. Green Gorilla 2M³ plasterboard offcut recycling bags can now be purchased as part of the GIB® Auckland Delivered to Site (DTS) service.

Simply order your Green Gorilla recycling bags when placing your GIB® DTS order and the bags will be delivered along with your plasterboard order direct to the building site.

Go to gib.co.nz/sustainability for further information.

