



**With MyGIB® you can now order and track
GIB® plasterboard from wherever, whenever.**

- Easily order GIB® plasterboard, select the delivery service and preferred merchant to order from your mobile device.
- Track order delivery status on your mobile device.
- Get instant Site Check and Proof of Delivery reports, with photos attached.
- CSV files available for quick and easy order importing into existing company ordering systems.

GET STARTED TODAY.



Select Product and Delivery Services

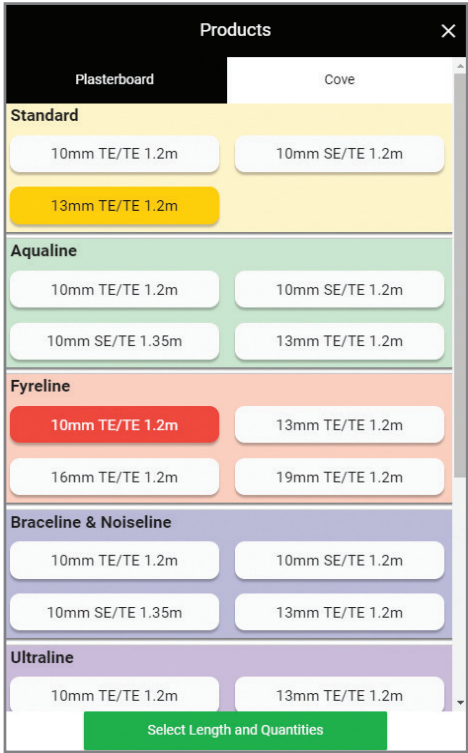

MyGIB® is simple and intuitive to use, where orders can be placed directly from the building site.

All available GIB® plasterboard is listed including available thickness, sheet width and length. GIB-Cove® options are under 'Cove' on the menu bar.

TIP – MyGIB® stores your past and current orders and keeps track of your changes to already submitted orders.

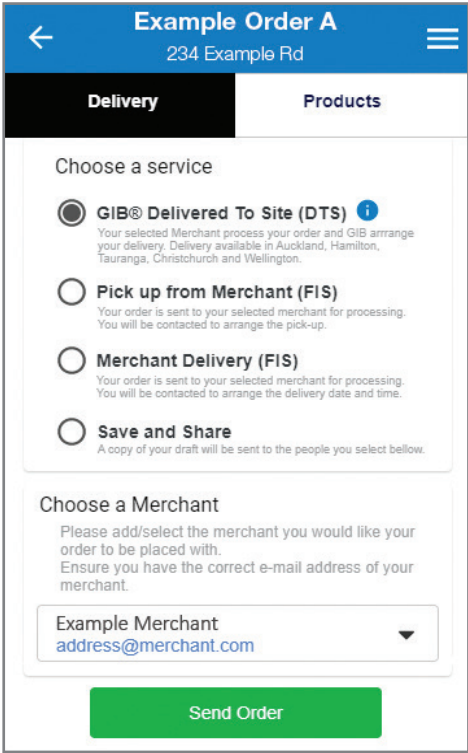

Choose between DTS and FIS orders and select or add your preferred merchant

NOTE – Your order still needs to be confirmed by your merchant!

The tracking service is available for DTS deliveries only.

After you click 'Send Order', an automated email will be sent to yourself and the selected merchant, including a PDF and CSV file of your order.

Track the Status of your Order

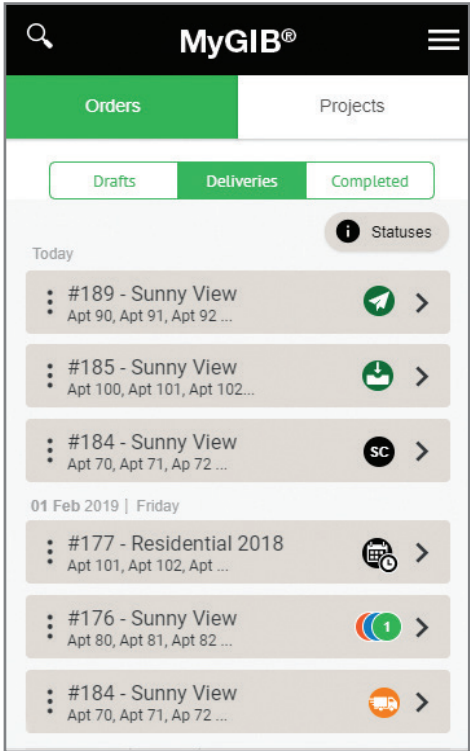

Icons give you a quick overview where your order is at in the delivery process. They will change according to the status of the process, like:



Order submitted



Site check done



On Route

By clicking on the grey bar, you can access the delivery details dashboard for more detailed information.

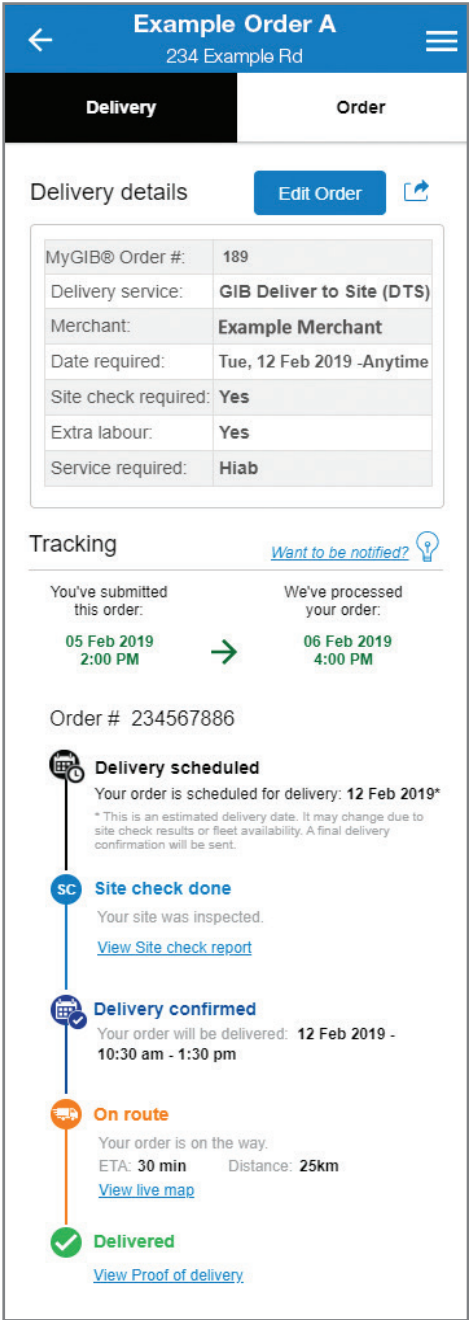

How to 'Get Started' with MyGIB®.

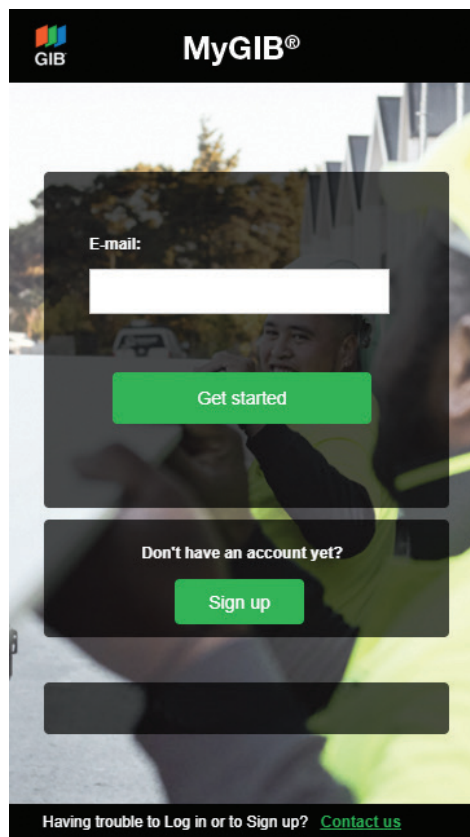

From Mobile or Tablet

Download the GIB® App from the App store or Google Play store then select MyGIB® Order and Track from the home screen.

From Desktop

Open your web browser (e.g. Google, Safari) and enter **mygib.gib.co.nz**

TIP – Bookmark the page for quick access to MyGIB® Order and Track.

Get Started or Sign up

If you are new to MyGIB®, sign up by entering your e-mail address, name and mobile number and click 'Register'. A verification code will then be sent to your e-mail address.

If you are already a MyGIB® user, enter your e-mail address and click 'Get started'. A verification code will then be sent to your e-mail address.

NOTE – Make sure you have got access to your e-mail account when signing up.

Still need help with MyGIB® or have feedback?

For further information and MyGIB® training material, including a short video, go to gib.co.nz/MyGIB or call the GIB® Contact Centre on 0800 475 475.

For any feedback and training requests send an e-mail to wwbdigitalteam@gib.co.nz